

PRODUCT MANUAL

KG-1096

PEX CLAMP CINCH TOOL

Ratcheting for Solid Connections

**MANUFACTURER:****ZHEJIANG IWISS ELECTRIC CO.,LTD
(IWISS TOOLS CO.,LTD)**

Add: No. 2789, Liule Road, Yueqing, Zhejiang, 325600, China.

Rebrand Notice

Both IWISS® and iCrimp® brands are known as members of Zhejiang IWISS Electric Co.,Ltd. We're pleased to inform you that the company is now taking the opportunity to consolidate two brands into one(iCrimp) in order to better communicate the breadth of expertise that the company represents.

Behind the new look we are still the same company and team dedicated to providing you the best possible quality and solution.

iCrimp
FOCUS ON CABLE & PIPE TOOLS

GENERAL INFORMATION

Tubing Compatibility:	PEX
Fitting System Compatibility:	Clamp
Application:	3/8" PEX 1/2" PEX 5/8" PEX 3/4" PEX 1" PEX
Type:	TOOL



FEATURES

- One master cinch tool installs all sizes from 3/8" to 1" of Cinch Clamps.
- With a unique "tab" design, the Cinch Tool goes into those hard-to-reach spaces.
- Ratchet design releases only when the cinch clamp tab is properly pinched, thus ensuring a leak-proof connection.
- Meets ASTM F-2098 specifications.
- Compresses Stainless Steel Clamp Rings to secure PEX or PE-RT tubing to brass or poly crimp fittings.

NOTE: Do not use with Zurn® Quickclamp™ PEX crimp PEX crimp rings.

OPERATION



CUT

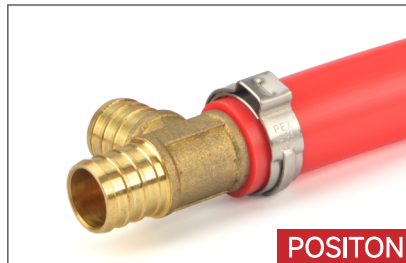

POSITION



PINCH



DONE

CALIBRATION

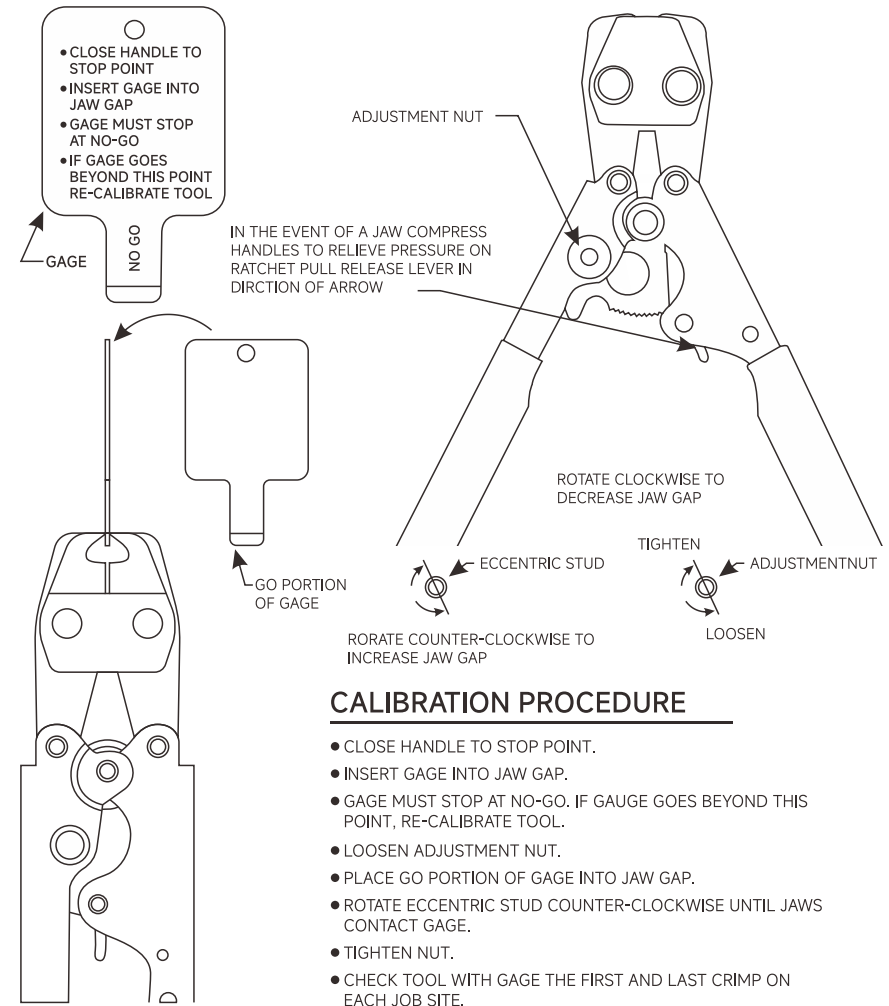

CLAMP REMOVAL

Recommended Tool: ICP-PC01

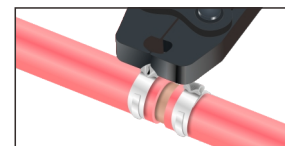

1. Place jaw tips on each side of clamp ear or clamp leg.

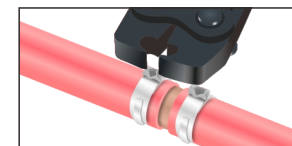

2. Squeeze handles.

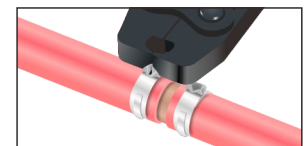

3. Cut through and remove clamp.