

# Submittal Data

PROJECT:	UNIT TAG:	QUANTITY:
REPRESENTATIVE: _____	TYPE OF SERVICE:	DATE: _____
ENGINEER:	SUBMITTED BY:	DATE:
CONTRACTOR:	APPROVED BY:	DATE:
	ORDER NO.:	DATE:

## COMFORT 10-16 T PM BU/LC



COMFORT is an efficient circulator designed for hot-water recirculation in domestic buildings with a dedicated return line. It features a built-in temperature sensor and control modes to limit heat losses.

Note! Product picture may differ from actual product

Conditions of Service		Pump Data		Motor Data	
Liquid:	Water	Liquid temperature range:	35.6 .. 176 °F	Max. power input:	6 W
Temperature:	140 °F	Pipe connection:	1 1/4" NPSM	Mains frequency:	60 Hz
Specific Gravity:	0.985	Product number:	99412493	Enclosure class:	IP44
				Thermal protection:	IMP.

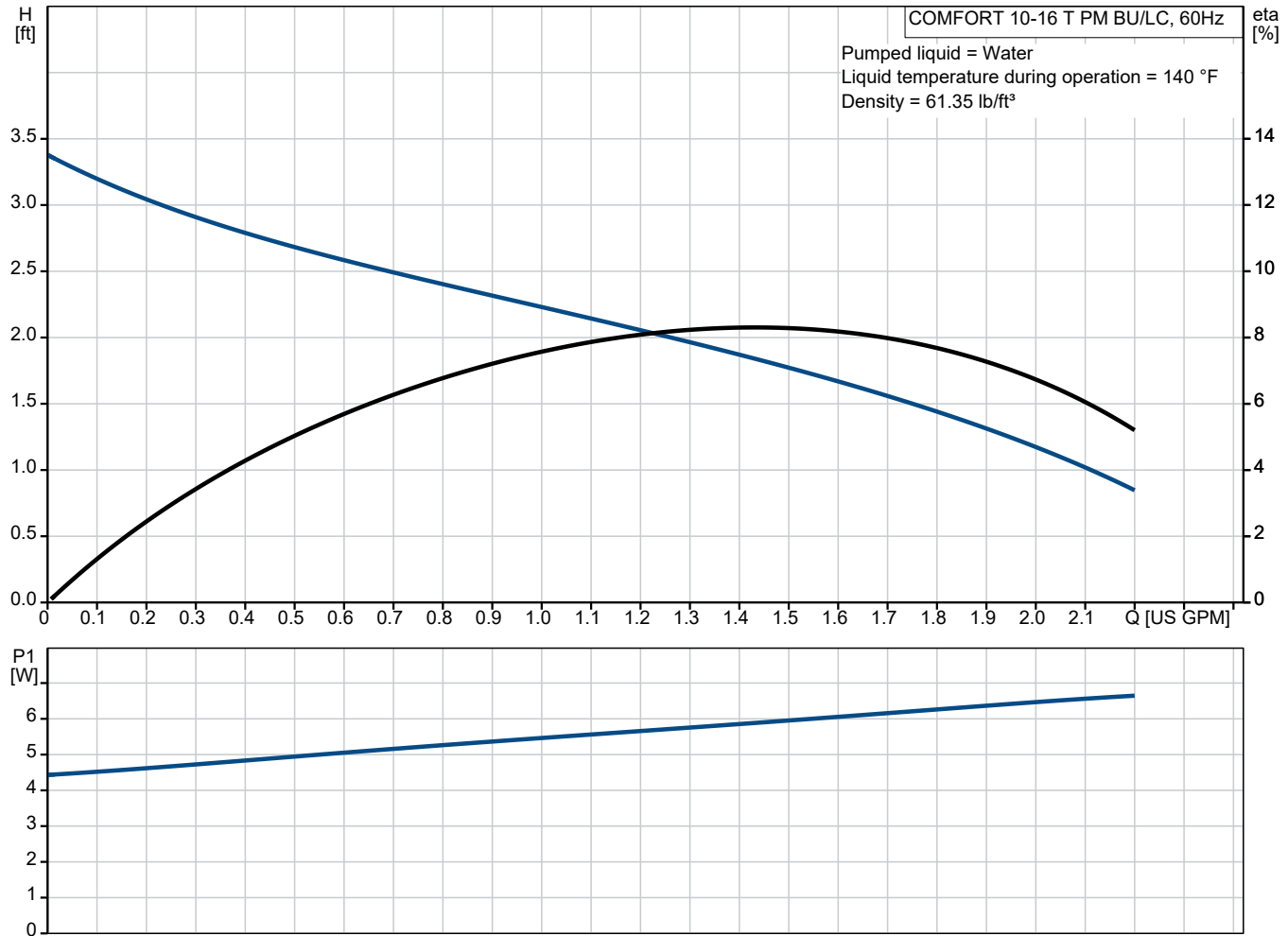

# Submittal Data

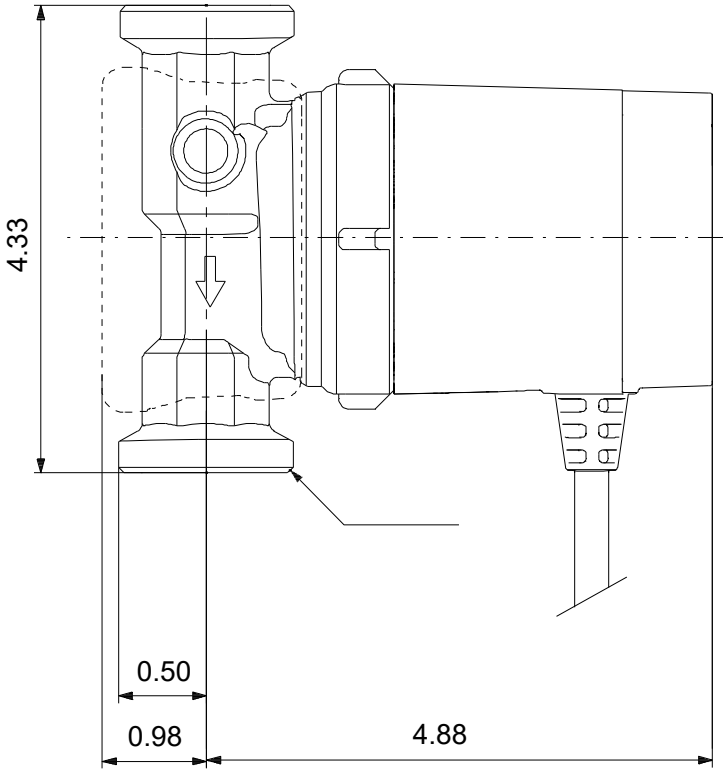
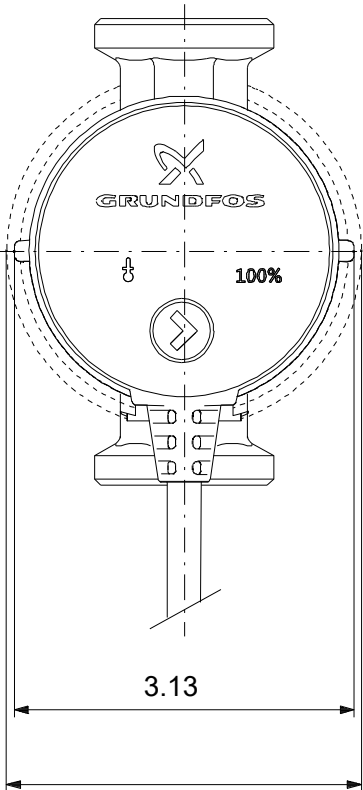

**Materials:**  
Pump housing: Brass  
Pump housing: ASTM B 505 ASTM B 371  
Impeller: Composite

Qty. Description

1 COMFORT 10-16 T PM BU/LC



Note! Product picture may differ from actual product

Product No.: [99412493](#)

The Grundfos COMFORT 10-16 T PM BU/LC pumps are designed for recirculation of domestic hot water in single

- and two-family houses securing hot water instantly to all faucets.

The pumps have a corrosion-resistant pump housing suitable for drinking water and are powered by a single-phase, high-efficiency ECM with permanent-magnet rotor.

The pump has an integrated temperature control mode that controls the circulation of domestic hot water based on the liquid temperature measured in the pump.

The temperature control mode uses an integrated temperature sensor to switch the pump on and off based on preset temperature limits.

These dynamic temperature limits are set automatically.

Manual setting is not needed.

Additionally, the pump can be set to continuous 100 % mode.

COMFORT 10-16 T PM BU/LC has a built-in isolating valve and a non-return valve. This ensures that maintenance can be carried out without draining the system. The non-return valve also prevents reversed flow during operation.

Features and benefits:

- Continuous 100 % mode for commissioning and temperature control mode to save heat energy.  
Quick and simple electrical installation.  
Dry-running protection protects the pump against dry running during startup and normal operation.  
Easy-to-clean and lime-resistant spheric rotor.  
Noiseless operation due to liquid-lubricated bearing.  
No leakage risk due to a static seal.  
Easy maintenance and cleaning through the easy-to-separate pump head.  
No additional motor protection necessary due to integrated motor electronics.



Company name:

Created by:

Phone:

Date:

19/07/2024

## 99412493 COMFORT 10-16 T PM BU/LC 60 Hz

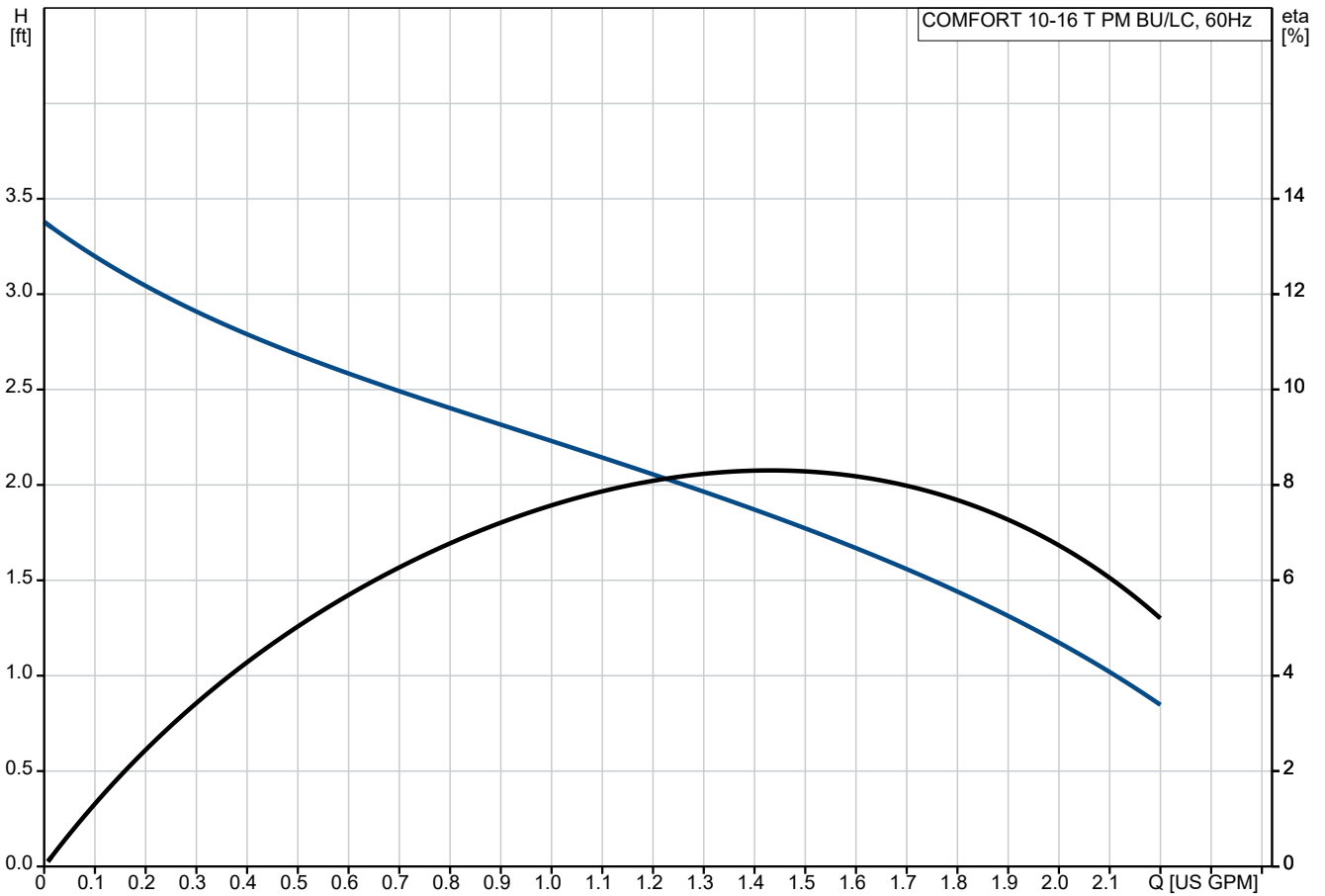

Pumped liquid = Water  
Liquid temperature during operation = 140 °F  
Density = 61.35 lb/ft<sup>3</sup>

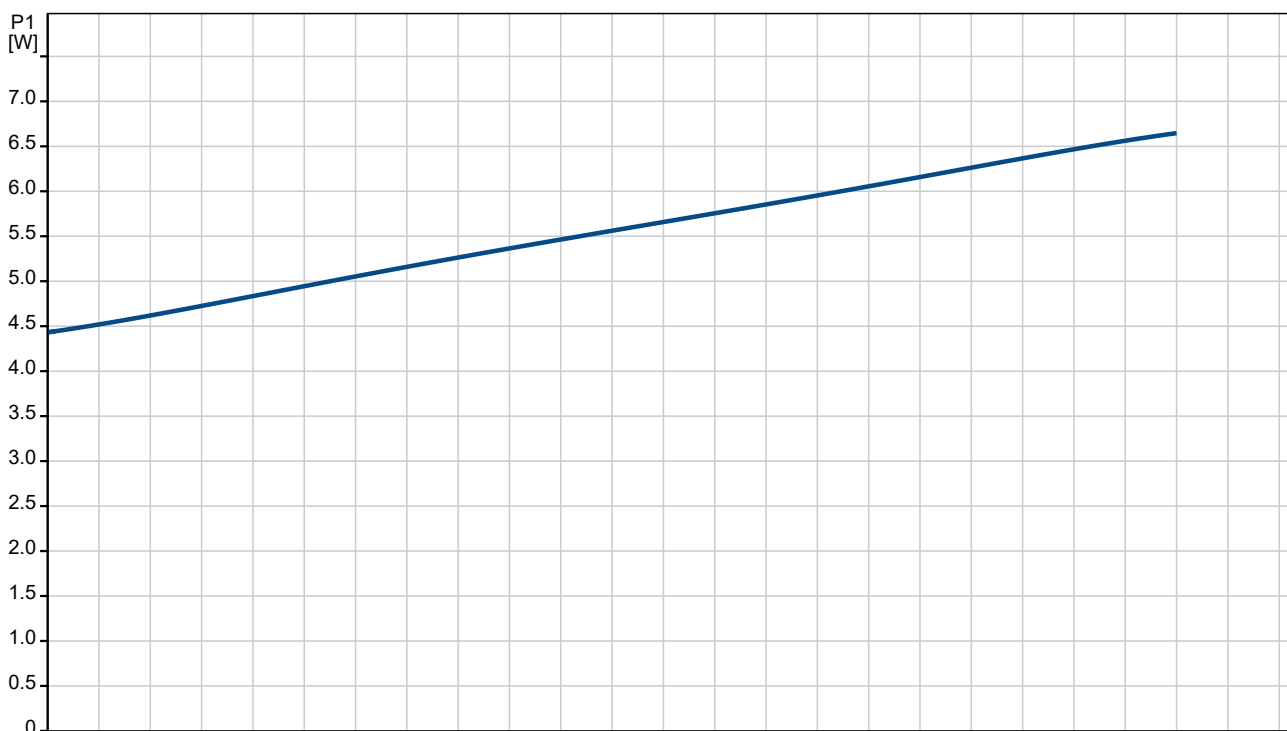

Description	Value
<b>General information:</b>	
Product name:	COMFORT 10-16 T PM BU/LC
Product No:	99412493
EAN number:	5713828699282
Price:	
<b>Technical:</b>	
Rated flow:	1.45 US GPM
Rated head:	1.841 ft
Head max:	5.25 ft
TF class:	95
Approvals:	UL,CSA
<b>Materials:</b>	
Pump housing:	Brass
Pump housing:	ASTM B 505 ASTM B 371
Impeller:	Composite
Impeller:	PES+30% GF
<b>Installation:</b>	
Maximum operating pressure:	145.04 psi
Type of connection:	1 1/4" NPSM
Pipe connection:	1 1/4" NPSM
Pressure rating for connection:	PN 10
Port-to-port length:	4 3/8 in
<b>Liquid:</b>	
Pumped liquid:	Water
Liquid temperature range:	35.6 .. 176 °F
Selected liquid temperature:	140 °F
Density:	61.35 lb/ft³
<b>Electrical data:</b>	
Max. power input:	6 W
Mains frequency:	60 Hz
Rated voltage:	1 x 115-230 V
Current in speed 3:	0.1 A
Enclosure class (IEC 34-5):	IP44
Insulation class (IEC 85):	F
Built-in motor protection:	NONE
Thermal protec:	IMP.
Cable type:	Connecting cord with plug
Type of cable plug:	NEMA 1-15P
<b>Others:</b>	
Net weight:	3.07 lb
Gross weight:	3.3 lb
Shipping volume:	0.12 ft³

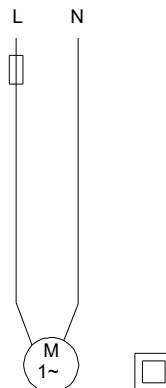
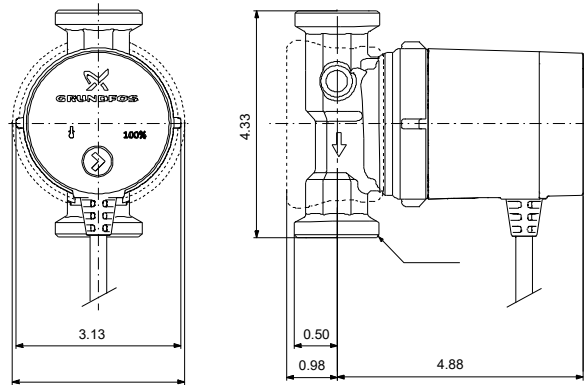
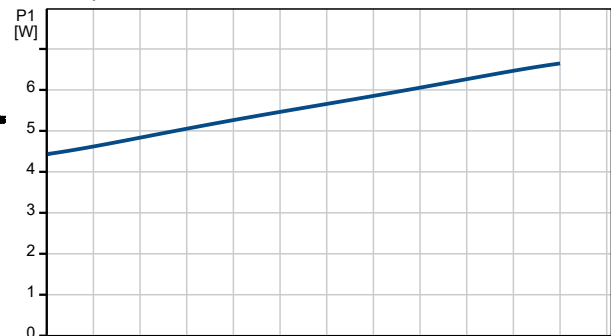
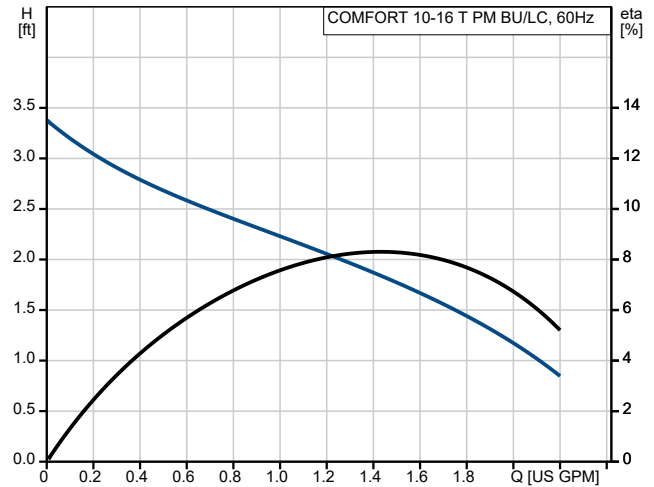

## 99412493 COMFORT 10-16 T PM BU/LC 60 Hz

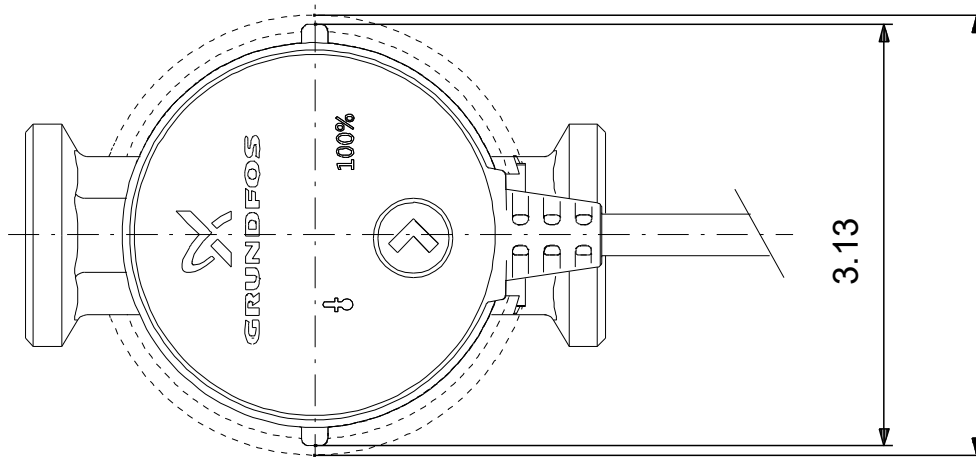
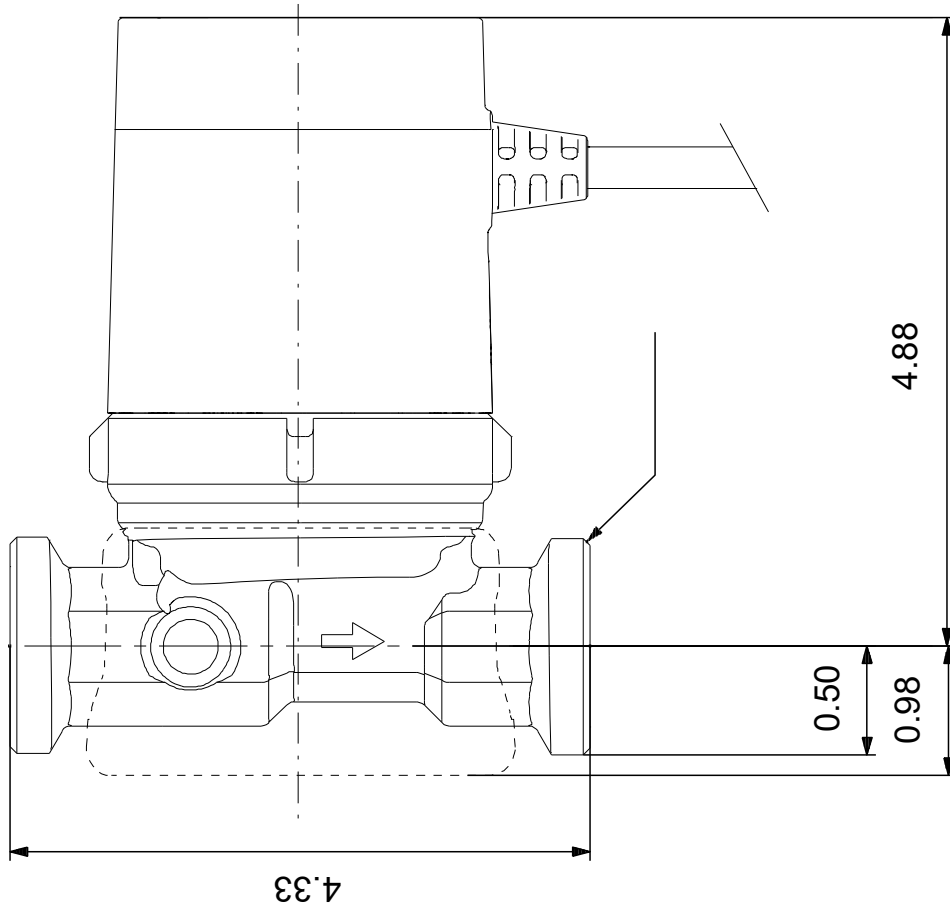

Note! All units are in [in] unless others are stated.  
Disclaimer: This simplified dimensional drawing does not show all details.

**99412493 COMFORT 10-16 T PM BU/LC 60 Hz**



Note! All units are in [in] unless others are stated.

